

---

This is an electronic reprint of the original article.  
This reprint may differ from the original in pagination and typographic detail.

Ahlava, Antti; Lages, Daniela; Kotyk, Angelina; Burista, Emese; Schwenk, Kai; Pilyov, Aleksandar; Mäkynen, Tommi; Niemeyer, Mirjam  
**Songdo Library International Competition Entry**

Published: 05/03/2020

*Document Version*  
Publisher's PDF, also known as Version of record

*Published under the following license:*  
Unspecified

*Please cite the original version:*  
Ahlava, A., Lages, D., Kotyk, A., Burista, E., Schwenk, K., Pilyov, A., Mäkynen, T., & Niemeyer, M. (2020). Songdo Library International Competition Entry: CHIRON. Architecture, Yeonsu-gu Office.

---

This material is protected by copyright and other intellectual property rights, and duplication or sale of all or part of any of the repository collections is not permitted, except that material may be duplicated by you for your research use or educational purposes in electronic or print form. You must obtain permission for any other use. Electronic or print copies may not be offered, whether for sale or otherwise to anyone who is not an authorised user.





AERIAL VIEW

# CHIRON

## The Placement in the Nerve Centre of the Site

The development direction of the design is based on the landscape, where it stems from. The placement of the building is in the middle of the site in order to leave enough open space and gardens surrounding the building, which has a symbiotic relationship with the site through the systems of circulation, energy, water, vegetation and heating. The central location enables the possible future expansion of the building as well. The diamond shape of the building creates four corner areas on the site with their different characteristics and different relationships to the surrounding plots. The library site becomes an outdoor livingroom for the citizens and has a large variety of different activity spots, as well and open flexible spaces for events.

## Contextual Divisioning of the Site

The north eastern corner is for easy access to the site with car and out to the garage and this area has been separated by vegetation from the actual entrance area of the museum.

The north western entrance area is the inviting open space for activities also with the neighbouring kindergarten. It connects with the neighbouring pedestrian circulation and green network.

The south-west corner has a rainwater pool and a fascinating pedestrian bridge over it from the street. The south eastern part connects the area with the gardens of the eastern side with its landscaped garden and the future public building. An important feature of the concept is the many connections across the site creating easy access from all directions and also through the building.

Land area | 7 182,21 m2  
Building area | 2 245,19 m2  
Total floor area | 8 716,06 m2  
Total floor area ratio | 92,4%  
Floor area ratio | 80%

Number of floors | 3 + cellar  
Landscape area | 1 935,46 m2  
Public open space | 6 610,71 m2  
Number of parking lots | 50



SITE PLAN 1:500



SOUTH EAST FACADE

## Sustainable and Eco-Friendly

We suggest eco-friendly components for environmentally sustainable systems, including renewable energy, rainwater use and biodiversity. The strategy for energy production for the library is to produce geothermal heating and cooling on the site under the garden surrounding the building. The garden also includes solar panels for the production of electricity. Rest of the electricity required is bought, sustainably produced electricity with green certification. The plan increases the biodiversity of the site. The use of renewable wood extensively in interiors supports the health and well-being of the users. There is rainwater management including a garden pool, the convex roof and the watering system for the hanging gardens in the main patio. The facade of the building has been designed to prevent excessive cooling or heating.

## Biotopes

The building is occupied and surrounded by vegetation in different scales, adding biodiversity. The building mass has been permeated with atrium spaces in outdoor space, that connects the floors and the roof garden. The largest patio has a hanging garden. The roof garden has a concave surface which makes it unique and also allows the gathering of rainwater.

## Building Materials

The materials of the building are sustainable, where the indoor surfaces are wooden. According to research, wooden interiors increase health and have a positive psychological effect to people.





INTERIOR PERSPECTIVE VIEW OF GROUND FLOOR LOUNGE/BOOK CAFE

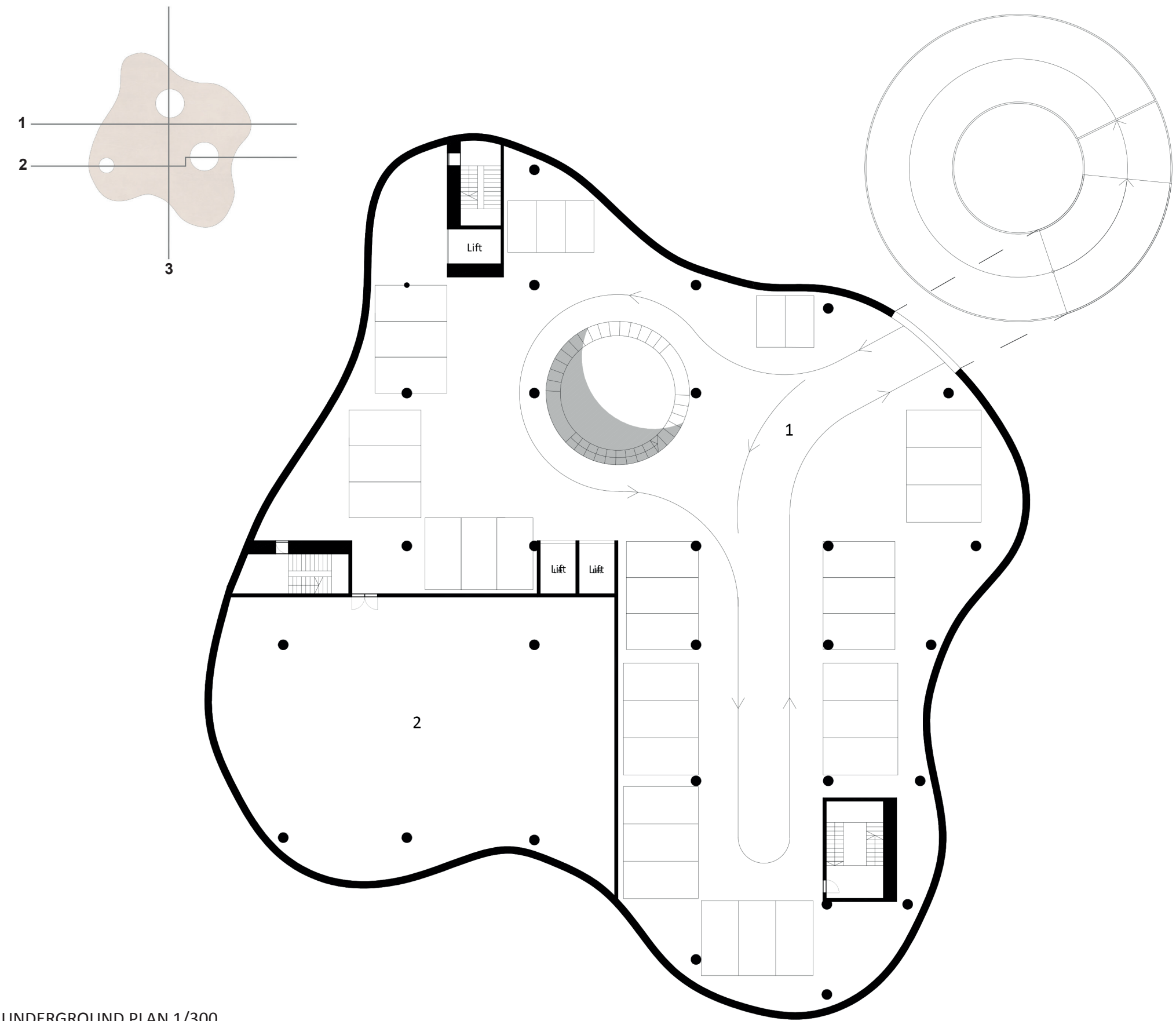

UNDERGROUND PLAN 1/300

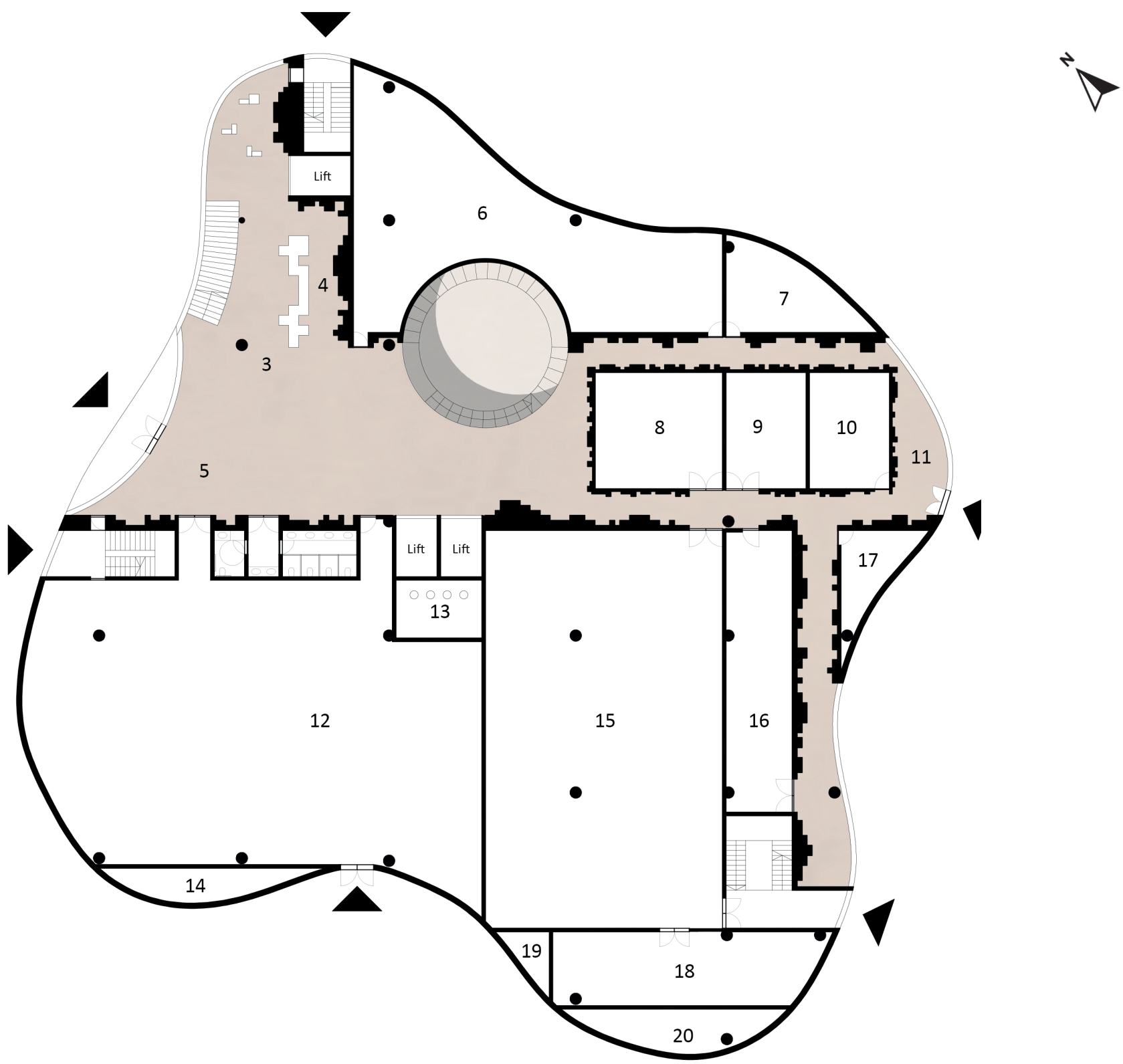

GROUND FLOOR PLAN 1/300

- 1. Underground Car Parking Lot 1481 m<sup>2</sup>
- 2. Technical Space (air conditioning machinery, heating and cooling control, electricity) 476 m<sup>2</sup>

- 3. Lounge 47.6 m<sup>2</sup>
- 4. Main Information Desk 27.2 m<sup>2</sup>
- 5. Book Cafe 238 m<sup>2</sup>
- 6. Office 183 m<sup>2</sup>
- 7. Office/Pantry/Lounge 34 m<sup>2</sup>
- 8. Conference Room 54 m<sup>2</sup>

- 9. Chief Executive Office 34 m<sup>2</sup>
- 10. Archive 34 m<sup>2</sup>
- 11. Workers' Cloak Space 20 m<sup>2</sup>
- 12. Auditorium 460 m<sup>2</sup>
- 13. Technical ducts 18.2 m<sup>2</sup>
- 14. Storage 18 m<sup>2</sup>

- 15. Preservation Room (Stacks) 343 m<sup>2</sup>
- 16. Incoming Materials/Arrangement 68 m<sup>2</sup>
- 17. Resting Zone for Sanitary Workers 19 m<sup>2</sup>
- 18. Server/Communications 70 m<sup>2</sup>
- 19. Technical 6.7 m<sup>2</sup>
- 20. Technical 25 m<sup>2</sup>



SECTION 1 1/300



SECTION 2 1/300





INTERIOR PERSPECTIVE VIEW OF THE 2ND FLOOR PATIO/LIBRARY SPACE



INTERIOR PERSPECTIVE VIEW OF THE 2ND FLOOR LIBRARY SPACE

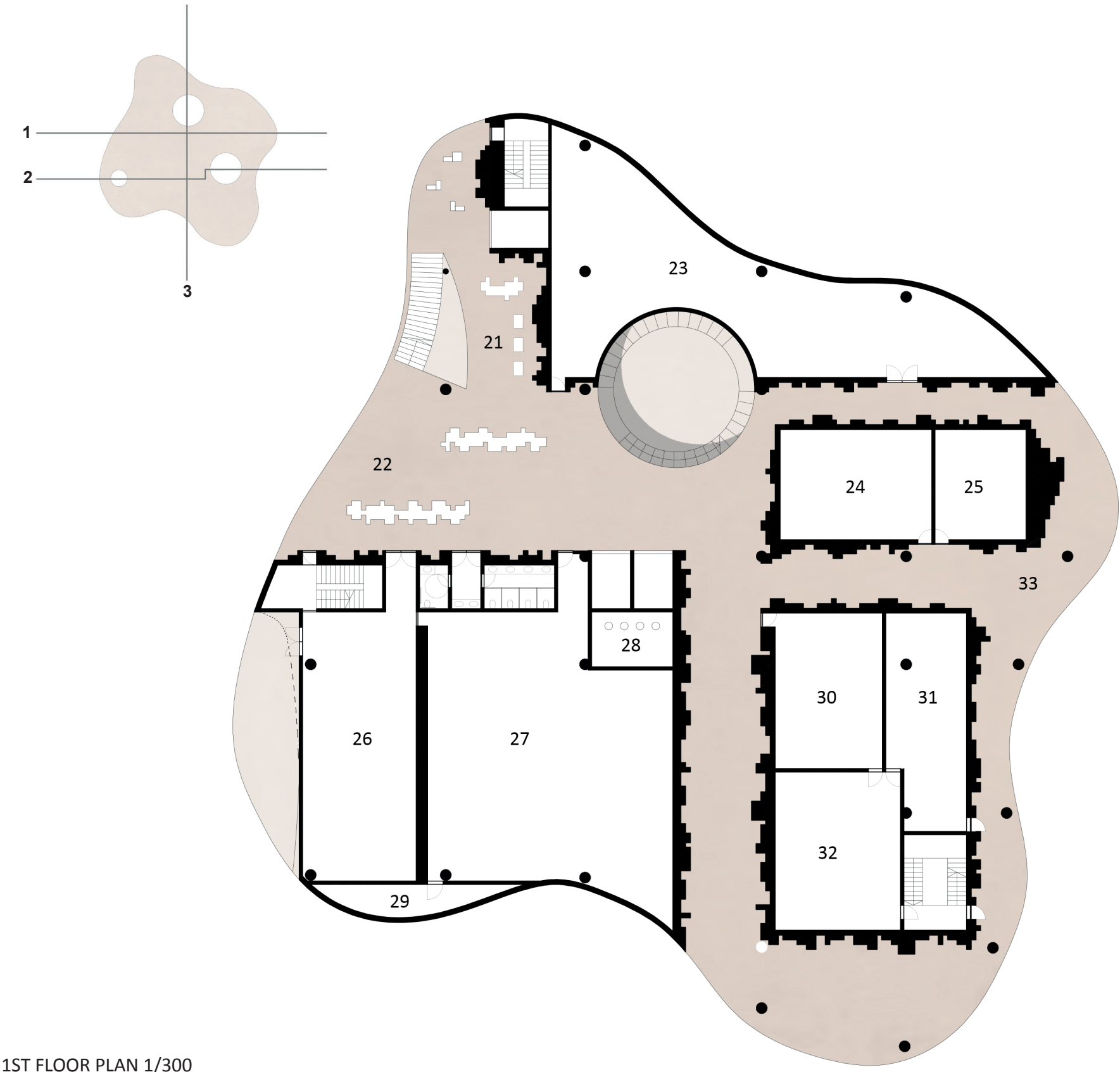

1ST FLOOR PLAN 1/300

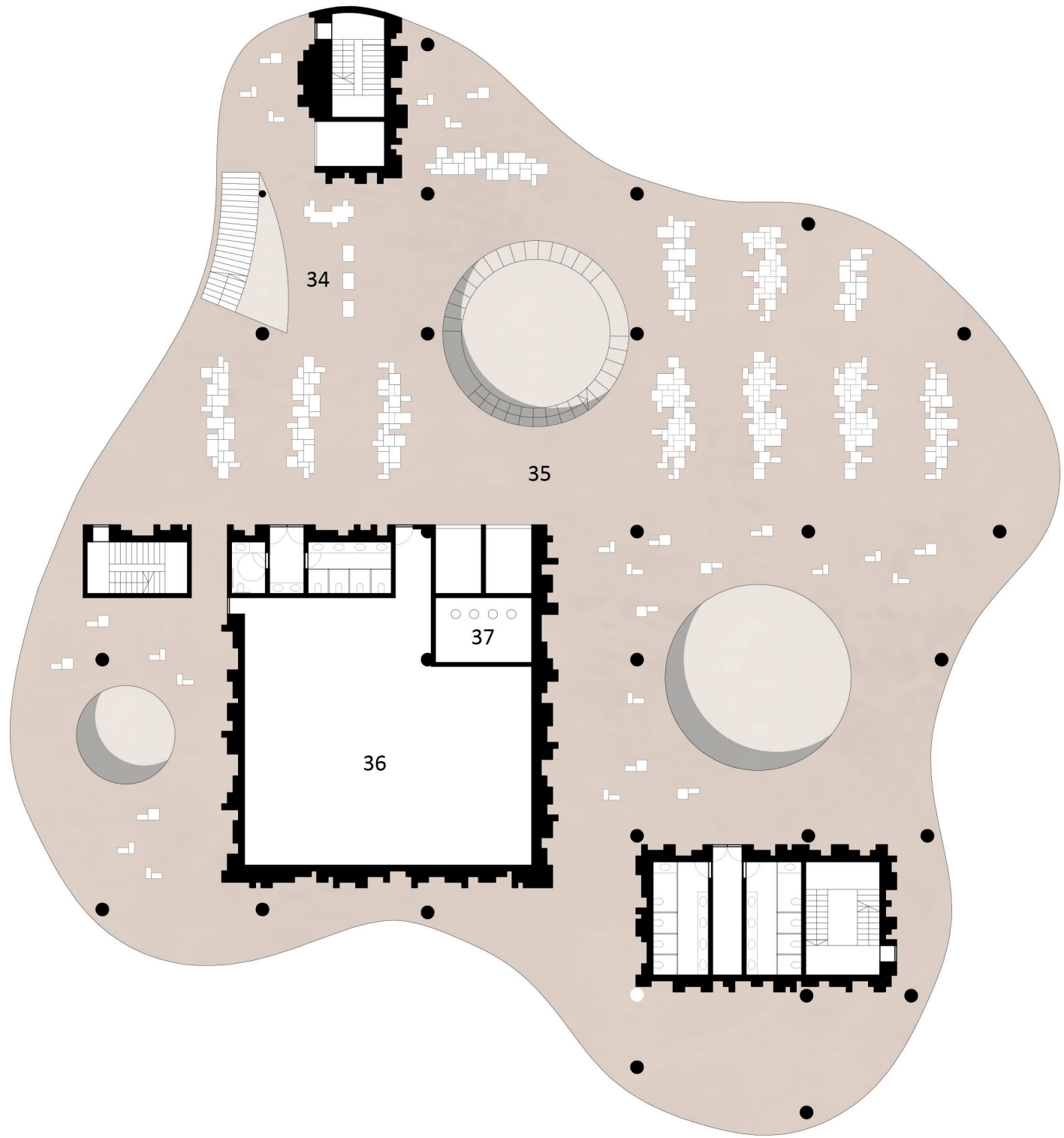

2ND FLOOR PLAN 1/300

- 21. Book Rental/Return 47.6 m<sup>2</sup>
- 22. Children's Materials 693.6 m<sup>2</sup>
- 23. Learning Space 218 m<sup>2</sup>
- 24. Club Room 68 m<sup>2</sup>
- 25. Volunteer Room 41 m<sup>2</sup>
- 26. Exhibition Space 131 m<sup>2</sup>
- 27. Multimedia 263 m<sup>2</sup>
- 28. Technical Ducts 18.2 m<sup>2</sup>
- 29. Storage 18 m<sup>2</sup>
- 30. Cultural Class 68 m<sup>2</sup>
- 31. Feeding Room 68 m<sup>2</sup>
- 32. Infant Material + Communications Room 81.6 m<sup>2</sup>
- 33. Common Space 151 m<sup>2</sup>

- 34. Book Rental/Return 47.6 m<sup>2</sup>
- 35. Library Space 1494.2 m<sup>2</sup>
- 36. Cultural/Educational Classroom 210 m<sup>2</sup>
- 37. Technical Ducts 18.2 m<sup>2</sup>



SECTION 3 1/300

NORTH EAST FACADE 1/300